

THANK YOU FOR CHOOSING ROBOTIQ

This step-by-step guide will allow you to install and test your Wrist Camera on Universal Robots.



1. WHAT IS SUPPLIED?

Standard upon delivery of a Wrist Camera kit for Universal Robots:

- Wrist Camera (RWC-CAM-001)
- Tool plate (RWC-TOOL-062)
- Calibration board (ACC-CALIB-BOARD)
- Color background (ACC-TEACH-BACK)
- 4-port USB hub splitter (ACC-USB-4-HUB)
- USB license dongle (ACC-USB-DONGLE)
- 16 Gb USB stick (ACC-USB-16G)
- Tags for Visual Offset (5) (ACC-TAG-1BAG5)
- Necessary hardware



2. TOOLS YOU NEED



2 mm Slotted Screwdriver



4 mm Hex Key

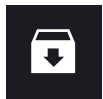

3. GET THE LATEST

Visit support.robotiq.com

- Download and unzip the content of the corresponding **UCC-X.X.X** version directly on a USB stick.
- Get the latest instruction manual.



4. MOUNTING

1. Mount the Wrist Camera on the robot arm.
2. Align the dowel pin.
3. Secure by inserting the M6 screws and tooth lock washers.
4. Mount the gripper directly on the Wrist Camera using the M5 screws and tooth lock washers provided with the gripper.



LEAVE ENOUGH EXCESS CABLE TO ALLOW FULL ROBOT MOVEMENT.

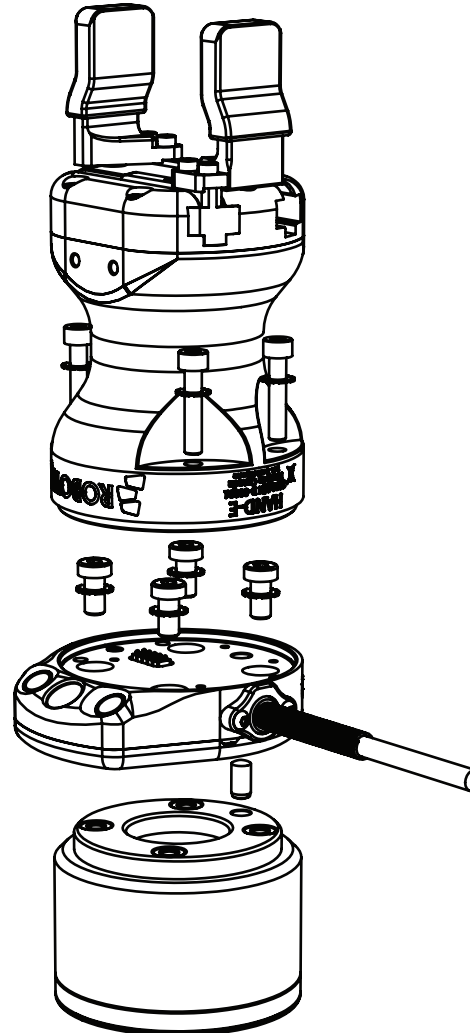

5. WIRING

- Connect the red wire of the device cable to a 24V pin of the robot controller.
- Connect the black wire of the device cable to a 0V pin of the robot controller.

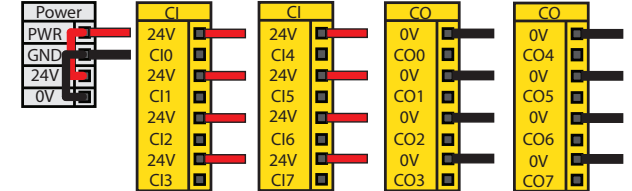

- Connect the 4 ports USB hub to the robot controller.
- Connect the Wrist Camera's USB cable in the USB hub.
- Connect the USB license dongle in the USB hub.



6. SOFTWARE INSTALLATION

For e-Series:

- Have a USB stick that contains the **UCC-X.X.X** uncompressed content (see step 3).
- With the controller on, insert the USB stick in the 4 ports USB hub.
- On the teach pendant, tap the **triple bar icon** in the upper right corner of the teach pendant and select **Settings**, then **System** in the left pane.
- Tap the **URCaps** submenu and then tap the + sign at the bottom of the screen.
- Open **Robotiq_Wrist_Camera-X.X.X.urcap** from the USB stick. Tap the **Restart** button.
- When PolyScope reopens, tap the **Installation** button.
- Select the **URCaps** menu in the left pane and tap the **Camera** button.
- Go to the **Dashboard** to verify that the system is up and running.

For CB-Series:

- Have a USB stick at hand that contains the **UCC-X.X.X** uncompressed content (see step 3).
- With the controller on, insert the USB stick in the 4 ports USB hub.
- From the PolyScope home page, tap **Setup Robot**.
- Go to **URCaps Setup** and tap the **+** sign.
- Open **Robotiq_Wrist_Camera-X.X.X.urcap** from the USB stick.
- Tap the **Restart** button.
- When PolyScope reopens, go to **Program Robot** and tap the **Installation** tab.
- Choose **Camera** and go to **Dashboard**.
- Verify that the system is up and running.



DO NOT REMOVE THE USB STICK AND THE USB LICENSE DONGLE, EVEN AFTER THE INSTALLATION HAS BEEN COMPLETED.



7. TEST WRIST CAMERA

For e-Series:

- Tap the **Installation** button and select the **URCaps** menu in the left pane.
- Select **Camera** and go to the **Dashboard** to verify that the system is running.
- Go to the **Camera** tab.
- The output image from the camera will display.

For CB-Series:

- From a robot program, go to the **Installation** tab and then select **Camera**.
- Select the **Dashboard** tab and verify that the vision system is running.
- Go to the **Camera** tab.
- The output image from the camera will appear.

➔ For help with troubleshooting, visit robotiq.com/support and the instruction manual for further information on how to program the Wrist Camera.



8. CALIBRATION

For e-Series:

- Tap the **URCaps** menu in the left pane and select **Camera**.
- Go to the **Snapshot** tab.
- Tap the **+** button to choose the calibration method.
- Follow the steps shown in the Teach Pendant.

For CB-Series:

- Go to **Camera** and then to the **Snapshot** tab.
- Tap **+** the button to choose the calibration method.
- Follow the steps shown in the Teach Pendant.



9. TEACH OBJECT

For e-Series:

- Tap the **Program** button.
- Select the **URCaps** menu in the left pane.
- Tap the **Cam Locate** button.
- Select the **Cam Locate** node in the program tree and tap the **Teach object** button in the **Command** tab to launch the object teaching wizard.
- You will need to select the previously taught calibration.

For CB-Series:

- From your robot program, go to the **Structure** tab.
- Go to the **URCaps** submenu.
- Tap the **Cam Locate** button.
- Go to the **Command** tab and tap **Teach object** to launch the object teaching wizard.
- You will need to select the previously taught calibration.



elearning.robotiq.com



robotiq.com/support

support@robotiq.com
T: 1.418.380.2788 ext. 3

X-990021-D
September 2020



WRIST CAMERA

QUICK START GUIDE

For installation on Universal Robots



X-990021-D